

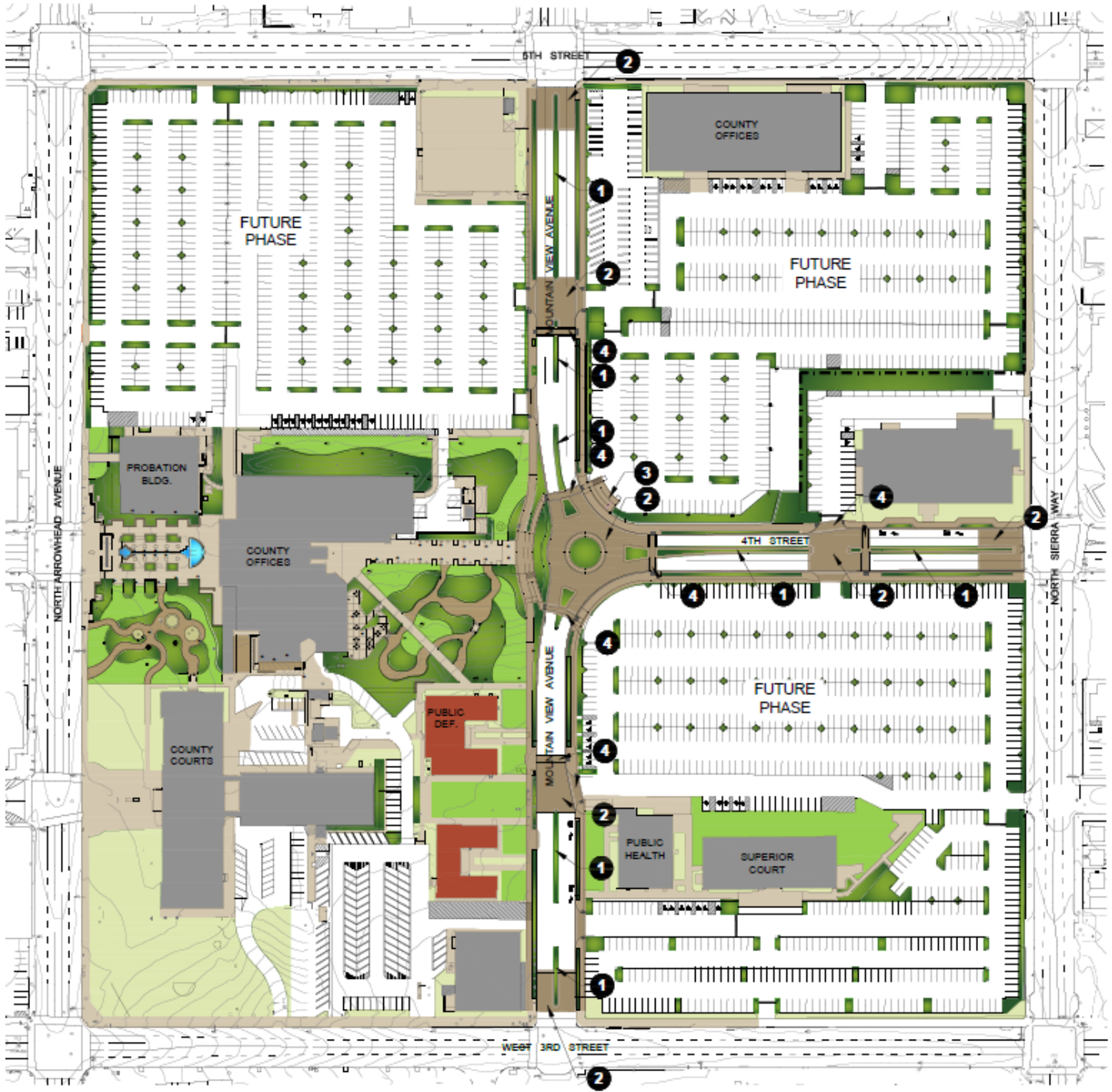

# DOWNTOWN GOVERNMENT CENTER COMPLEX IMPROVEMENT PROJECT SAN BERNARDINO, CALIFORNIA



## LEGEND

- ❶ PLANTING WITHIN MEDIAN
- ❷ DECORATIVE PAVEMENT AT GOVERNMENT CENTER ENTRY POINTS.
- ❸ NEW RETAINING WALL AND RAMP/STAIR COMBO
- ❹ CROSSWALK

COPYRIGHT © 2014  
 NOTE: THIS INFORMATION IS UNOFFICIAL, UNFINAL AND SUBJECT TO CHANGE WITHOUT NOTICE. FOR OFFICIAL INFORMATION AND DECISIONS, PLEASE REFER TO THE OFFICIAL RECORDS OF THE PROJECT.  
 OCTOBER 11, 2017

## PROPOSED MASTER SITE PLAN

1275 Greenleaf Drive  
 Pasadena, CA 91104  
 T: 626 799 8300  
 F: 626 799 8100

